

Threaded End Connection

Series D "9D" Nickel Aluminum Bronze

- 100% Made in USA
- Top Entry Swing Check Valve
- To 2000 PSI WP
- 1" Through 4"
- ASTM B148 GR 955 "9D"
- Threaded Body Construction
- NACE Standard
- Enhanced Protection Against CO₂ and Saltwater Corrosion
- Replaceable 316 Stainless Steel Disc Standard
- Exceptional Yield Strength
- Improved by Design for Easier Bonnet Removal
- Minimizes Risk of Galling Associated with Stainless Steel



Material Description

ITEM	PART NAME	DESCRIPTION
1	Body	ASTM B148 GR 955
2	Bonnet	ASTM B148 GR 955
3	Bonnet Seal	Fluorocarbon
4A	Disc	Replaceable 316 Stainless Steel
4B	Disc Hanger	316 Stainless Steel
5	Disc Seal	Fluorocarbon
6*	Pipe Plug	316 Stainless Steel

* Not available in 1"

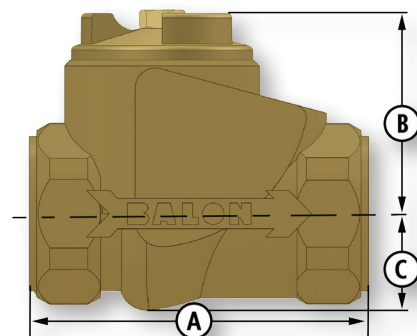
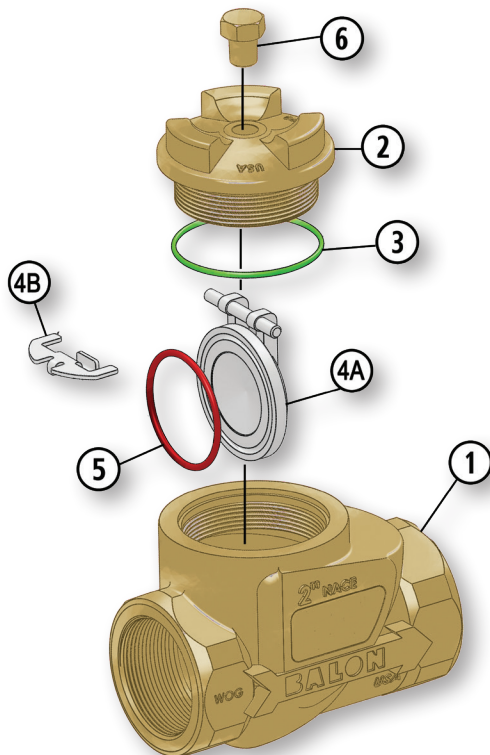

Dimensional Data

SIZE	CATALOG	PORT	WP	A	B	C	LBS.
1	1F-D94-SE	1	2000	4.25	2.87	1.12	4
2	2F-D44-SE	2	1000	6.00	3.75	1.87	9.8
2	2F-D94-SE	2	2000	6.00	3.75	1.87	11
3	3F-D44-SE	3	1000	8.00	4.45	2.43	21
4	4F-D44-SE	4	1000	10.00	5.54	3.00	36